

**C-700 Series
Digital Locking**

Cylinder

Modular Assembly Manual

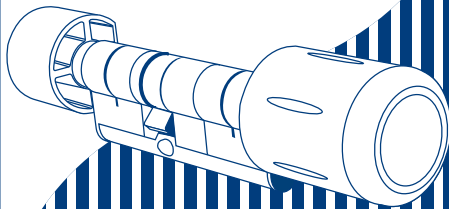

www.waferlock.com

Parts list for Tool Kit

- Ⓐ Connect Bodies and pins:
5mm x 12, 10mm x 12, and 15mm x 4
- Ⓑ Bridges: 30/35 x 6, 35/35 x 6, 35/40 x 6, 40/40 x 6, 40/45 x 3, and 45/45 x 3
- Ⓒ Connect Body Set Screws: 35mm x 18, 40mm x 18, and 45mm x 6
- Ⓓ Bridge Screws: 50pcs
- Ⓔ Reader Knob Screws: 50pcs
- Ⓕ Steel Balls: 50pcs
- Ⓖ Anti-pulling Pins: 20pcs
- Ⓗ Anti-drilling Pins: 20pcs
- Ⓖ Seal Rings inside Reader Knob: 10pcs
- Ⓘ Assembly Holder: 1pc
- Ⓚ Knob Cap Assembly Tool: 1pc

Length Adjustment

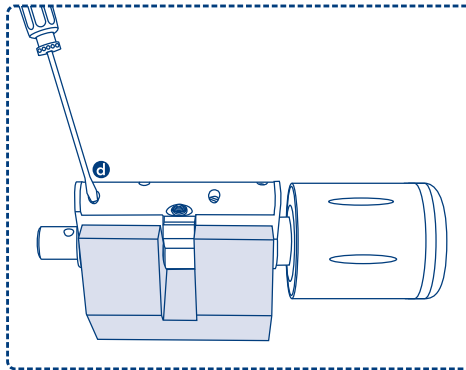

- ① Slide cylinder into assembly holder.
② Loosen all screws[Ⓓ] on bridge with flathead screwdriver.

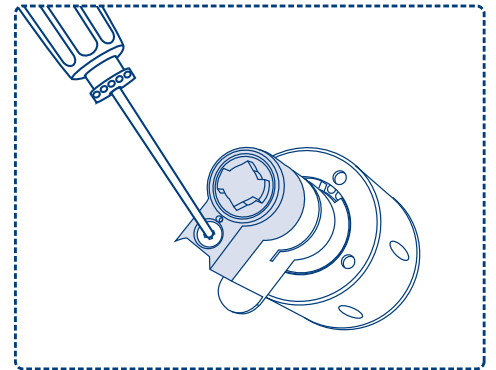

- ⑤ Tighten screw[Ⓒ] of connect body set on Reader Knob part and Inner Knob part with Phillips screwdriver.

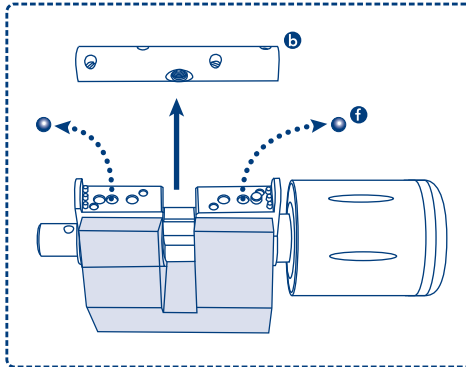

- ② Remove bridge[Ⓑ] from the top of cylinder carefully. There are two steel balls[Ⓕ] in between. Please keep steel balls[Ⓕ] in a container to prevent from loss during the length adjustment.

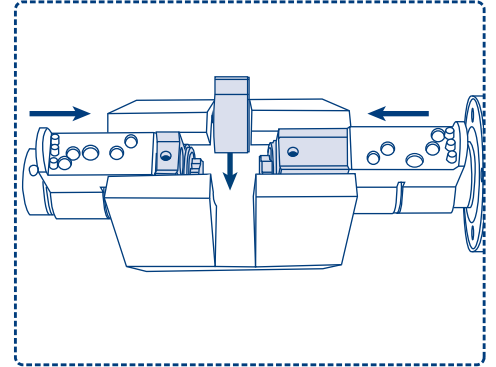

- ⑥ Assemble three parts: Reader Knob part, Cam, and Inner Knob part.

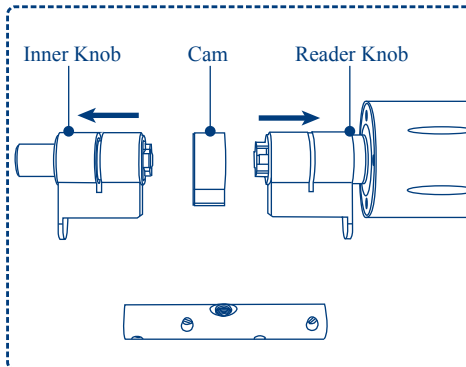

- ③ Take apart cylinder into three sections: Reader Knob part, Cam, and Inner Knob part.

★ There is size indicator on the bridge

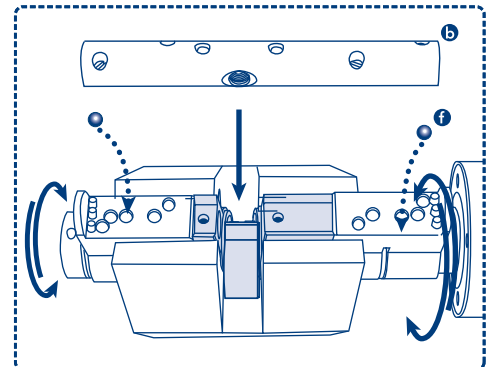

- ⑦ ① Slightly turn reader knob and inner knob to fit into cam.
② Put steel balls[Ⓕ] back to the original position.
③ Select appropriate bridge and assemble it.

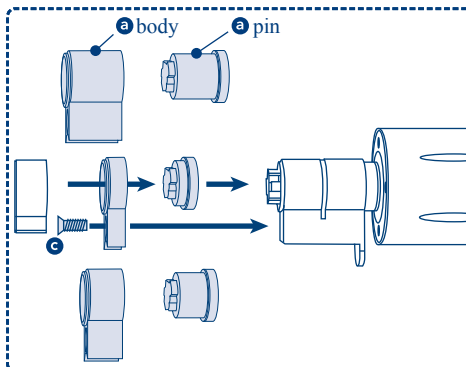

- ④ Select a specified length connect body set[Ⓐ] or combination with screws[Ⓒ] for Reader Knob part and Inner Knob part.

★ Please refer to Length Assembly Diagram for connect body set selection.

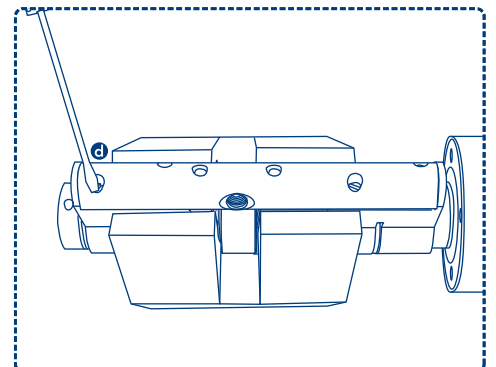

- ⑧ Tighten bridge screws[Ⓓ] with flathead screwdriver.

© Length Assembly Diagram

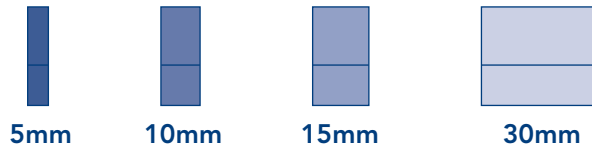

Measurements indicated in mm

